



CLEAN AUDITS SINCE 2010/11



*Ons gee gestalte aan 'n beter toekoms!  
We shape a beter future!  
Sibumba ikamva elingcono!*

File ref: 15/3/13-1/Erf\_1606, 1447

Enquiries:  
Mr AJ Burger

25 January 2022

Diesel & Munns Inc.  
P O Box 475  
SOMERSET WEST  
7129

**By Registered Mail**

Dear Sir/Madam

**PROPOSED EXEMPTION FOR THE SUBDIVISION OF ERF 1606 (PORTION OF ERF 1447),  
ABBOTSDALE**

Your application with reference number C6150/190, dated 18 January 2022, on behalf of SANRAL, refers.

The proposed subdivision as presented in this application complies with the requirements of Section 34 of Swartland Municipal: Municipal Land Use Planning By-Law (PG 8226 of 25 March 2020) and is thus exempted from approval from Swartland Municipality.

Please provide Swartland Municipality with approved Surveyor General Diagram.

Yours sincerely

  
**MUNICIPAL MANAGER**  
per Department Development Services  
AJB/ds

Copies: Land Surveyor General Private Bag X9028, Cape Town, 8000

NT-1 JOB: PSS058 RDS:77518 ACQ PLANO:7\_075\_112\_1

| SIDES<br>Metres          |        | DIRECTIONS        | CO-ORDINATES<br>Y System WG19° X |                       |
|--------------------------|--------|-------------------|----------------------------------|-----------------------|
|                          |        | <b>Constants:</b> | ±                                | 0,00 +3 700 000,00    |
| AB                       | 13,62  | 308 14 40         | A +                              | 30 324,30 + 6 681,53  |
| BC                       | 86,28  | 34 42 10          | B +                              | 30 313,60 + 6 689,97  |
| CD                       | 95,65  | 31 13 20          | C +                              | 30 362,72 + 6 760,90  |
| DE                       | 15,96  | 131 03 10         | D +                              | 30 412,30 + 6 842,70  |
| EF                       | 118,08 | 211 17 30         | E +                              | 30 424,34 + 6 832,22  |
| FA                       | 63,06  | 217 52 30         | F +                              | 30 363,01 + 6 731,31  |
| (254) Molenberg          |        |                   | △ +                              | 34 410,38 + 14 175,33 |
| (26) Staart V Paardeberg |        |                   | △ +                              | 23 126,19 + 6 131,73  |

**S.G. No.**  
  
**Approved**  
  
**for**  
**Surveyor-**  
**General**

**SWARTLAND MUNISIPALITEIT**  
**SWARTLAND MUNICIPALITY**

Vrygestel ingevolge artikel 34 van die Verordening insake  
Munisipale Grondgebruikbeplanning (PK 8226 van 25 Maart  
2020).

Exempted in terms of section 34 of the Municipal Land Use  
Planning By-Law (PN 8226 of 25 March 2020).

2022/01/25  
DATUM/DATE

*An Bayman*  
MUNISIPALE BESTUURDER 866  
MUNICIPAL MANAGER

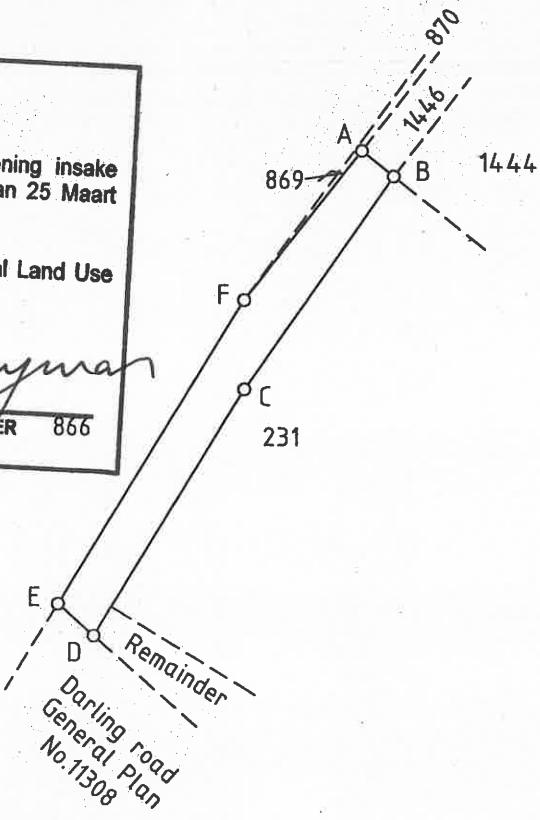

Description of Beacons:  
Y-Type iron standard: A,B,C,F  
Hole in concrete: D  
Hole in tar: E

The figure A B C D E F  
represents 2841 square metres of land, being  
ERF 1606 (a portion of Erf 1447) ABBOTSDALE  
Situate in the Swartland Municipality  
Administrative District of Malmesbury  
Province of Western Cape

Surveyed in February to May 2007 and October 2021 by me  
*J. Lake*  
J. Lake Land Surveyor (PLS 0328)

|  |   |  |
|--|---|--|
| This diagram is annexed to<br><br>No.<br>dated<br>i.f.o.<br><br>Registrar of Deeds | The original diagram is<br>No.729/2017<br><br>annexed to<br>Deed of Transfer<br>No. | File No.<br><br>S.R. No.1079/2007 and<br><br>Comp.BHNY-3451(M4170) |
|  |   |  |