



CLEAN AUDITS SINCE 2010/11



*Ons gee gestalte aan 'n beter toekoms!
We shape a beter future!
Sibumba ikamva elingcono!*

File ref: 15/3/13-15/Farm_577/08

Enquiries:
Mr AJ Burger

11 February 2022

SBA Towers SA
100 Cecilia Street
Cecilia Square Building
PAARL
7646

By Registered Mail

Dear Sir/Madam

PROPOSED EXEMPTION OF SUBDIVISION FROM APPROVAL FOR THE REGISTRATION OF A LEASE AREA OVER FARM OUDE POST NO. 577/08

Your application with reference ATSA774, dated 8 February 2022, on behalf of Wilfred Duckitt and Sons refers.

The registration of a lease area (100m² in extent) on a portion on Farm 557/08, complies with the requirements of Section 34 of Swartland Municipal Land Use Planning By-Law (PG 8226 of 25 March 2020) and is thus exempted from approval from Swartland Municipality.

Please provide Swartland Municipality with approved Surveyor General Diagram.

Yours sincerely

MUNICIPAL MANAGER
per Department Development Services
AJB/ds

Copies: *Land Surveyor General Private Bag X9028, Cape Town, 8000
Wilfred Duckitt & Sons, P O Box 141, DARLING, 7345*

Rig asseblief alle korrespondensie aan:

Die Munisipale Bestuurder
Privaatsak X52
Malmesbury 7299

Darling Tel: 022 492 2237

Tel: 022 487 9400

Faks/Fax: 022 487 9440

Epos/Email: swartlandmun@swartland.org.za

Moorreesburg Tel: 022 433 2246

Kindly address all correspondence to:

The Municipal Manager
Private Bag X52
Malmesbury 7299

Yzerfontein Tel: 022 451 2366

LEASEHOLD DIAGRAM

STEPHEN OLD - Land Surveyors

SIDES Metres		ANGLES OF DIRECTION	CO-ORDINATES Y System WG 19° X		S.G. No.
		Constants	+ 0,00	+ 0,00	
AB	10,00	221 53 20	A	+56 010,49	APPROVED for Surveyor-General Date
BC	10,00	311 53 20	B	+56 003,81	
CD	10,00	41 53 20	C	+55 996,36	
DA	10,00	131 53 20	D	+56 003,04	
Connection Data					
DE	260,00	311 53 20	E	+55 809,49	+3 699 524,83
(11)	Kapokberg	△	+56 052,73	+3 699 327,04	
(465)	Groote Post	△	+56 998,02	+3 701 752,43	

Beacon Descriptions

A, B, C, D 16mm Round iron peg
E 25mm Pipe in concrete

Portion 8
of the farm
OUDE POST
No. 577

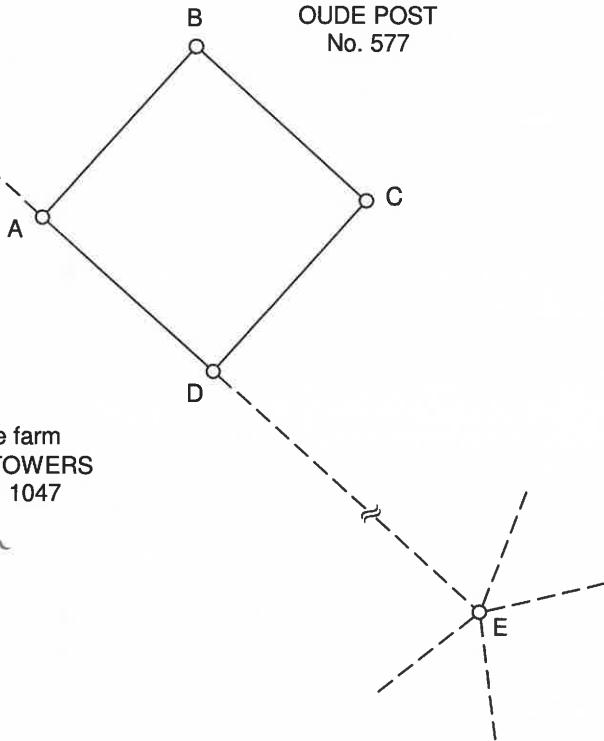

SWARTLAND MUNISIPALITEIT
SWARTLAND MUNICIPALITY

Vrygestel ingevolge artikel 34 van die Verordening insake Munisipale Grondgebruikbeplanning (PK 8226 van 25 Maart 2020).

Exempted in terms of section 34 of the Municipal Land Use Planning By-Law (FN 8226 of 25 March 2020).

2022/02/11
DATUM/DATE

[Signature]
MUNISIPALE BESTUURDER
MUNICIPAL MANAGER

SCALE 1:300

The figure A B C D represents 100 square metres of land, being
LEASE AREA NO. 1 OVER PORTION 8 OF THE FARM OUDE POST NO. 577
Situate in the Swartland Municipality
Administrative District of Malmesbury
Province of Western Cape

Surveyed in February 2019
by me

[Signature]
S.R. OLD (PLS 0984)
Professional Land Surveyor

This diagram is annexed to Deed of Number dated i.f.o. Registrar of Deeds	The original diagram is S.G. No. 12306 / 1984 annexed to Deed of Transfer No. 1990 - - 22676	S.G. File : Malm. 577 (Vol.) S.R. No. Comp : BH-3D (3688) LPI C0460000
--	--	--