



CLEAN AUDITS SINCE 2010/11



*Ons gee gestalte aan 'n beter toekoms!
We shape a beter future!
Sibumba ikamva elingcono!*

File ref: 15/3/13-15/Farm_821/76

Enquiries:
Mr AJ Burger

8 August 2022

Diesel & Munns Inc.
PO Box 475
SOMERSET WEST
7129

Attention: Jonathan Lake

admin@dieselandmunns.co.za

Per Registered Post

Dear Sir/Madam

**PROPOSED EXEMPTION FOR SUBDIVISION OF PORTION 13 OF FARM GROENE RIVIER,
DIVISION MALMESBURY**

Your application, with reference number C6150/196, dated 15 July 2022, on behalf of SANRAL, refers.

The proposed subdivision of portion 13 of farm Groene Rivier no 821, Divisoin, Malmesbury, complies with the requirements of Section 34 of Swartland Municipality: Municipal Land Use Planning By-Law (PG 8226 of 25 March 2020) and is thus exempted from approval from Swartland Municipality.

Please provide Swartland Municipality with approved Surveyor General diagrams.

Yours sincerely



MUNICIPAL MANAGER
per Department Development Services
AJB/Us

Copies: *Land Surveyor General Private Bag X9028, Cape Town, 8000*

PS5058 RDS No. 70946 O/7/075/52/1 N7/1

SIDES Metres	ANGLES OF DIRECTION	CO-ORDINATES Y System: WG 19° X		S.G. No.		
		Constants	±0,00		±0,00	
A B	10,38	27.40.30	A	+34 803,88	+3 715 077,24	Approved for Surveyor-General
B C	389,98	29.26.00	B	+34 808,70	+3 715 086,43	
C D	6,42	150.05.00	C	+35 000,35	+3 715 426,07	
D E	80,39	208.18.10	D	+35 003,55	+3 715 420,51	
E A	316,78	210.39.50	E	+34 965,44	+3 715 349,73	
(225) Boterberg			△	+40 829,19	+3 724 221,69	
(254) Molenberg			△	+34 410,38	+3 714 175,33	

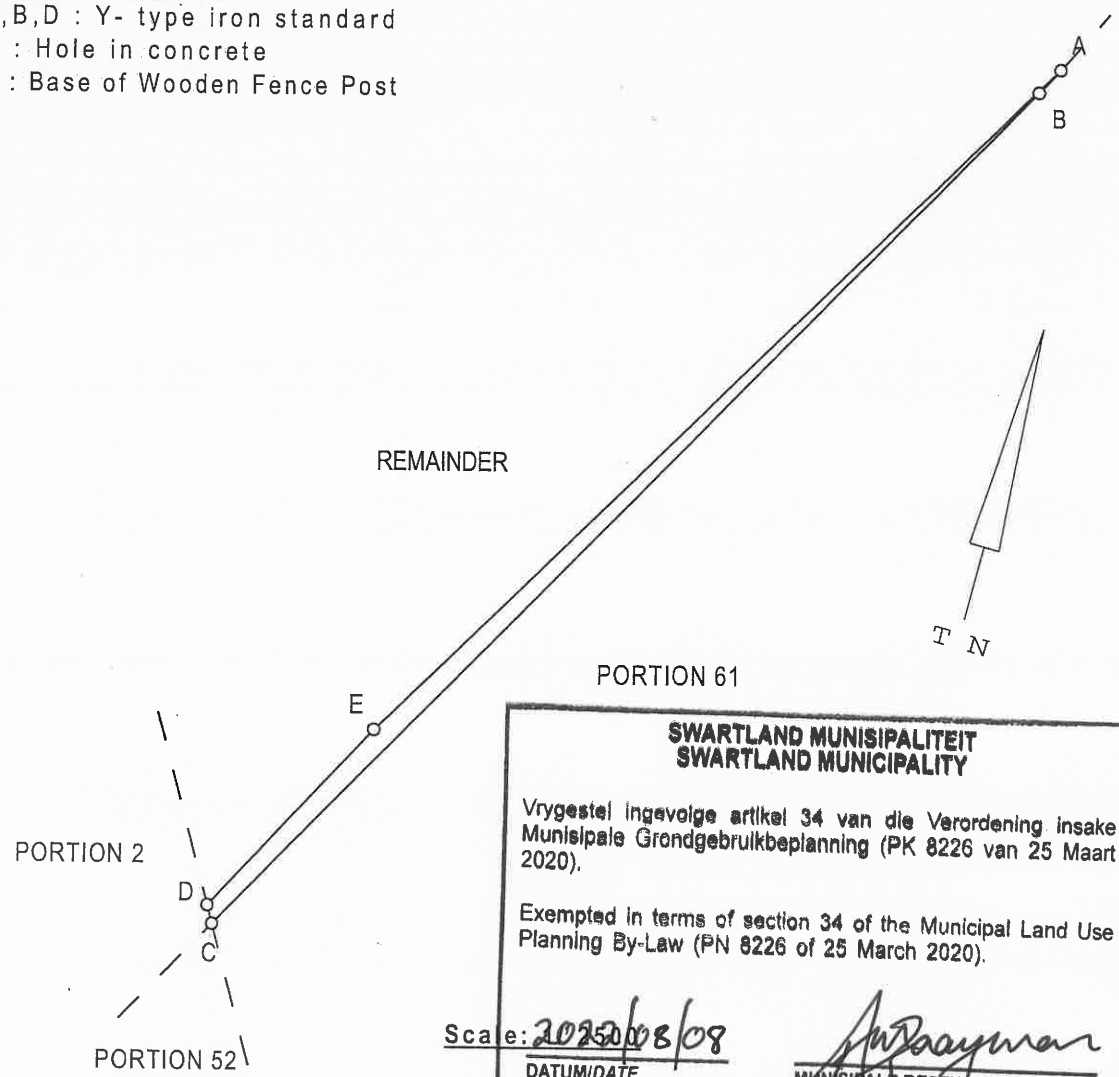
Beacon Descriptions
 A, B, D : Y- type iron standard
 C : Hole in concrete
 E : Base of Wooden Fence Post



**SWARTLAND MUNISIPALITEIT
 SWARTLAND MUNICIPALITY**

Vrygestel ingevolge artikel 34 van die Verordening insake
 Munisipale Grondgebruikbeplanning (PK 8226 van 25 Maart
 2020).

Exempted in terms of section 34 of the Municipal Land Use
 Planning By-Law (PN 8226 of 25 March 2020).

Scale: 2025/08/08
 DATUM/DATE

[Signature]
 MUNISIPALE BESTUURDER
 MUNICIPAL MANAGER

The figure A B C D E
 represents 1 692 square metres of land, being
PORTION 76 (a portion of Portion 13) of the farm GROENE RIVIER No. 821

Situate in the Swartland Municipality
 Administrative District of Malmesbury
 Province of the Western Cape
 Surveyed in June 2022
 by me,

[Signature]
 S SIBIYA (PLS 1404)
 Professional Land Surveyor

This Diagram is annexed to No. dated i. f. o Registrar of Deeds	The original diagram is No. 9934/1993 Annexed to D/T 1994- -31270	File No. Malm. 821 S.R. No. Comp. BH-6AB(3712) BH-6AC3713 LPI CO460000
---	--	--