



CLEAN AUDITS SINCE 2010/11
SKOON OUDITS SEDERT 2010/11



Munisipaliteit
Municipality
Umasipala

Ons gee gestalte aan 'n beter toekoms!
We shape a better future!
Sakha ikusasa elingcono!

File ref: 15/3/13-15/Erf 414/17

Enquiries:
A. de Jager

24 October 2022

Diesel & Munns Inc.
PO Box 475
SOMERSET WEST
7129

Per Registered Post

Dear Sir/Madam

PROPOSED EXEMPTION FROM APPROVAL FOR SUBDIVISION OF PORTION 28, 29 AND 30 (PORTIONS OF PORTION 17) OF THE FARM ZWARTFONTEIN, NO 414, DISTRICT MALMESBURY

Your application, with reference number C6150/202, dated 6 September 2022, on behalf of the South African National Roads Agency Limited, refers.

The subdivision of Portions 28, 29 and 30 (Portions of Portion 17) of the Farm Zwartfontein, no. 414, Division Malmesbury, in order to accommodate road widening in favour of the N7 highway, Section 2, complies with the requirements of Section 34 of Swartland Municipality: Municipal Land Use Planning By-Law (PG 8226 of 25 March 2020) and is thus exempted from approval from Swartland Municipality;

Kindly provide Swartland Municipality with copies of the approved Surveyor General diagrams for record keeping purposes.

Yours sincerely

MUNICIPAL MANAGER
per Department Development Services
Adj/ds

Copies: *Land Surveyor General Private Bag X9028, Cape Town, 8000*
Director: Civil Engineering Services

NT-2JOB:PS5062 RDS:83723 ACQ. PLAN 0-7-082-2-1

SIDES Metres	DIRECTIONS	CO-ORDINATES		S.G. No.
		Y	X	
	Constants:	±	0,00	+3 600 000,00
AB	53,38	1 57 10	A + 29 736,42	+ 71 504,60
BC	2,00	317 01 50	B + 29 738,24	+ 71 557,95
CD	10,47	271 58 20	C + 29 736,88	+ 71 559,41
DE	9,00	1 54 40	D + 29 726,42	+ 71 559,77
EF	10,48	91 58 10	E + 29 726,72	+ 71 568,76
FG	2,00	46 49 20	F + 29 737,19	+ 71 568,40
GH	249,85	1 57 40	G + 29 738,65	+ 71 569,77
HJ	50,93	351 57 50	H + 29 747,20	+ 71 819,47
JK	113,24	1 57 50	J + 29 740,08	+ 71 869,90
KL	47,44	343 31 40	K + 29 743,96	+ 71 983,07
LM	17,08	325 34 40	L + 29 730,51	+ 72 028,56
MN	25,90	25 00 30	M + 29 720,85	+ 72 042,65
NP	47,43	20 23 40	N + 29 731,80	+ 72 066,12
PQ	89,11	1 57 40	P + 29 748,33	+ 72 110,58
QR	46,16	11 57 50	Q + 29 751,38	+ 72 199,64
RS	80,17	1 57 30	R + 29 760,95	+ 72 244,80
ST	2,00	317 01 50	S + 29 763,69	+ 72 324,92
TU	9,62	270 46 30	T + 29 762,33	+ 72 326,38
UV	9,20	1 48 20	U + 29 752,71	+ 72 326,51
VW	9,64	91 57 40	V + 29 753,00	+ 72 375,77
WX	2,41	38 03 50	W + 29 762,63	+ 72 387,57
XY	5,82	138 32 30	X + 29 764,11	+ 72 387,57
YZ	266,64	181 56 40	Y + 29 767,97	+ 72 382,56
Z1A	26,06	266 10 20	Z + 29 758,92	+ 72 066,12
1AM	25,13	208 41 30	1A + 29 732,92	+ 72 064,64
M1B	29,31	120 39 00	L + 29 720,85	+ 72 042,65
1B1C	8,88	134 08 50	1B + 29 746,07	+ 72 027,77
1C1D	9,00	149 46 20	1C + 29 752,45	+ 72 021,52
1D1E	493,84	181 57 40	1D + 29 756,97	+ 72 013,75
1EA	16,02	193 10 30	1E + 29 740,07	+ 71 520,20
	(147) Mooresburg	▲	+ 31 013,50	+ 73 588,17
	(301) Kleinvlei	▲	+ 27 311,79	+ 66 811,77

Approved
for
Surveyor-
General

Sheet 1 of
2 Sheets

SWARTLAND MUNISIPALITEIT
SWARTLAND MUNICIPALITY
 2022/10/24
 MUNICIPAL ENGINEER
 J. Lake

Vrygestel ingevolge artikel 34 van die Verordening insake
 Munisipale Grondgebruikbeplanning (PK 8226 van 25 Maart
 2020).
 Exempted in terms of section 34 of the Municipal Land Use
 Planning By-Law (PN 8226 of 25 March 2020).

Description of Beacons
All are Y-type iron standard

Servitude Note
The line xy represents the centre line of an Electric Power Line
Servitude 15,74m wide, vide Diagram SG No.3398/1970

The figure A B C D E F G H J K L M N P Q R S T U V W
X Y Z 1A M 1B 1C 1D 1E
represents 6518 square metres of land, being
PORTION 28 (a portion of Portion 17) of the farm ZWARTFONTEIN No.414
Situate in the Swartland Municipality
Administrative District of Malmesbury
Province of Western Cape
Surveyed in April to May 2007 and August 2022 by me
J Lake Land Surveyor (PLS 0328)

This diagram is annexed to No. dated i.f.o. Registrar of Deeds	The original diagram is No. 1741/2020 annexed to Deed of Transfer No. 1921-88-5484	File No. S.R.No.1556/2007 and Comp. BH-2CBC(3671)
--	--	---

N7-2JOB:PS5062 RDS:83723 ACQ. PLAN 0-7-082-2-1

S.G. No.

Approved

Surveyor-General

Sheet 2 of 2 Sheets



Scale 1:5000

Portion 25

Remainder

**SWARTLAND MUNISIPALITEIT
SWARTLAND MUNICIPALITY**

Vrygestel ingevolge artikel 34 van die Verordening insake
Munisipale Grondgebruikbeplanning (PK 8226 van 25 Maart
2020).

Exempted in terms of section 34 of the Municipal Land Use
Planning By-Law (PN 8226 of 25 March 2020).

2022/10/24
DATUM/DATE

[Signature]
MUNISIPALE BESTUURDER
MUNICIPAL MANAGER

INSET 1 SCALE 1:1000

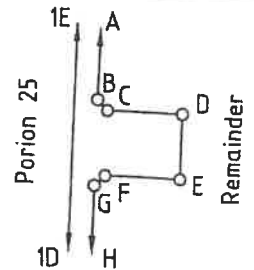

INSET 2 SCALE 1:1000

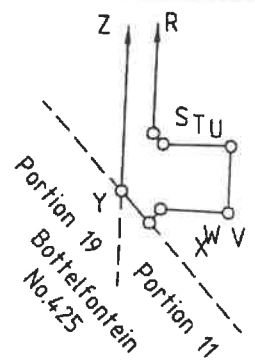

Portion 19
Bottelfontein No.425
Portion 11

See INSET 2

[Signature]

J Lake Land Surveyor (PLS 0328)

N7-2JOB:PS5062 RDS:83878 ACQ. PLAN 0-7-082-2-1

SIDES Metres	DIRECTIONS	CO-ORDINATES Y System WG19°X		S.G. No. Approved for Surveyor- General	
		Constants:	±		
			±	0,00	+3 600 000,00
AB	11,81	2 01 20	A	+ 29 771,76	+ 71 555,27
BC	1,99	135 36 30	B	+ 29 772,18	+ 71 567,07
CD	7,78	90 31 00	C	+ 29 773,57	+ 71 565,65
DE	9,00	180 30 30	D	+ 29 781,35	+ 71 565,58
EF	8,09	270 29 40	E	+ 29 781,27	+ 71 556,58
FA	1,98	225 48 50	F	+ 29 773,18	+ 71 556,65
(147) Mooresburg		▲	+	31 013,50	+ 73 588,57
(301) Kleinvlei		▲	+	27 311,79	+ 66 810,45

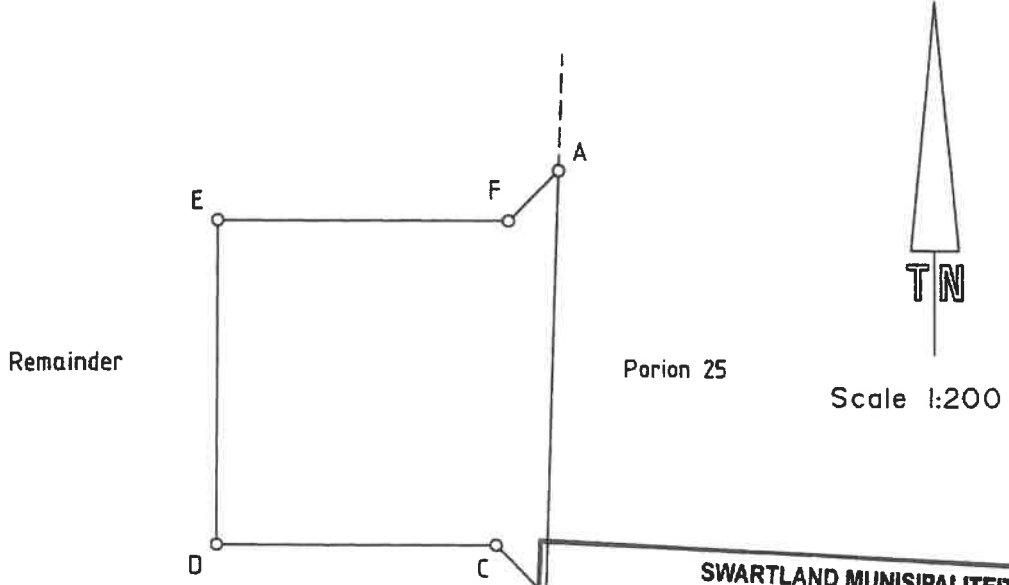

Description of Beacons
All are Y-type iron standard

**SWARTLAND MUNISIPALITEIT
SWARTLAND MUNICIPALITY**

Vrygestel ingevolge artikel 34 van die Verordening insake
Munisipale Grondgebruikbeplanning (PK 8226 van 25 Maart
2020).

Exempted in terms of section 34 of the Municipal Land Use
Planning By-Law (PN 8226 of 25 March 2020).

2022/10/24
DATUM/DATE

J. Bayman
MUNISIPALE BESTUURDER
MUNICIPAL MANAGER

The figure A B C D E F
represents 86 square metres of land, being
PORTION 29 (a portion of Portion 17) of the farm ZWARTFONTEIN No.414
Situat in the Swartland Municipality
Administrative District of Malmesbury
Province of Western Cape

Surveyed in April to May 2007 and August 2022 by me
J Lake Land Surveyor (PLS 0328)

This diagram is annexed to No. dated i.f.o. Registrar of Deeds	The original diagram is No. 1741/2020 annexed to Deed of Transfer No. 1921-88-5484	File No. S.R.No.1556/2007 and Comp. BH-2CBC(3671)
--	--	---