



CLEAN AUDITS SINCE 2010/11
SKOON OUDITS SEDERT 2010/11



Munisipaliteit
Municipality
Umasipala

Ons gee gestalte aan 'n beter toekoms!
We shape a better future!
Sakha ikusasa elingcono!

File ref: 15/3/13-8/Erf_571, 1669

Enquiries:
A. de Jager

26 October 2022

CK Rumboll & Partners
P.O. Box 211
MALMESBURY
7299

Per Registered Post

Dear Sir/Madam

PROPOSED EXEMPTION FROM APPROVAL FOR THE CONSOLIDATION OF ERVEN 571 AND 1669, MALMESBURY

Your application, with reference number MAL/12808/NG/EB, dated 12 October 2022, on behalf of Swartland Municipality, refers.

- A. The consolidation of Erven 517 and 1669, Malmesbury complies with the requirements of Section 34 of Swartland Municipality: Municipal Land Use Planning By-Law (PG 8226 of 25 March 2020) and is thus exempted from approval from Swartland Municipality.

Kindly provide Swartland Municipality with copies of the approved Surveyor General diagrams for record keeping purposes.

Yours sincerely

MUNICIPAL MANAGER
per Department Development Services
Adj/ds

Copies: *Land Surveyor General Private Bag X9028, Cape Town, 8000*

CONSOLIDATION OF ERVEN 571 AND 1669, MALMESBURY

**SWARTLAND MUNISIPALITEIT
SWARTLAND MUNICIPALITY**

Vrygestel ingevolge artikel 34 van die Verordening insake
Munisipale Grondgebruikbeplanning (PK 8226 van 25 Maart
2020).

Exempted in terms of section 34 of the Municipal Land Use
Planning By-Law (PN 8226 of 25 March 2020).

2022/10/26
DATUM/DATE

[Signature]
MUNISIPALE BESTUURDER
MUNICIPAL MANAGER

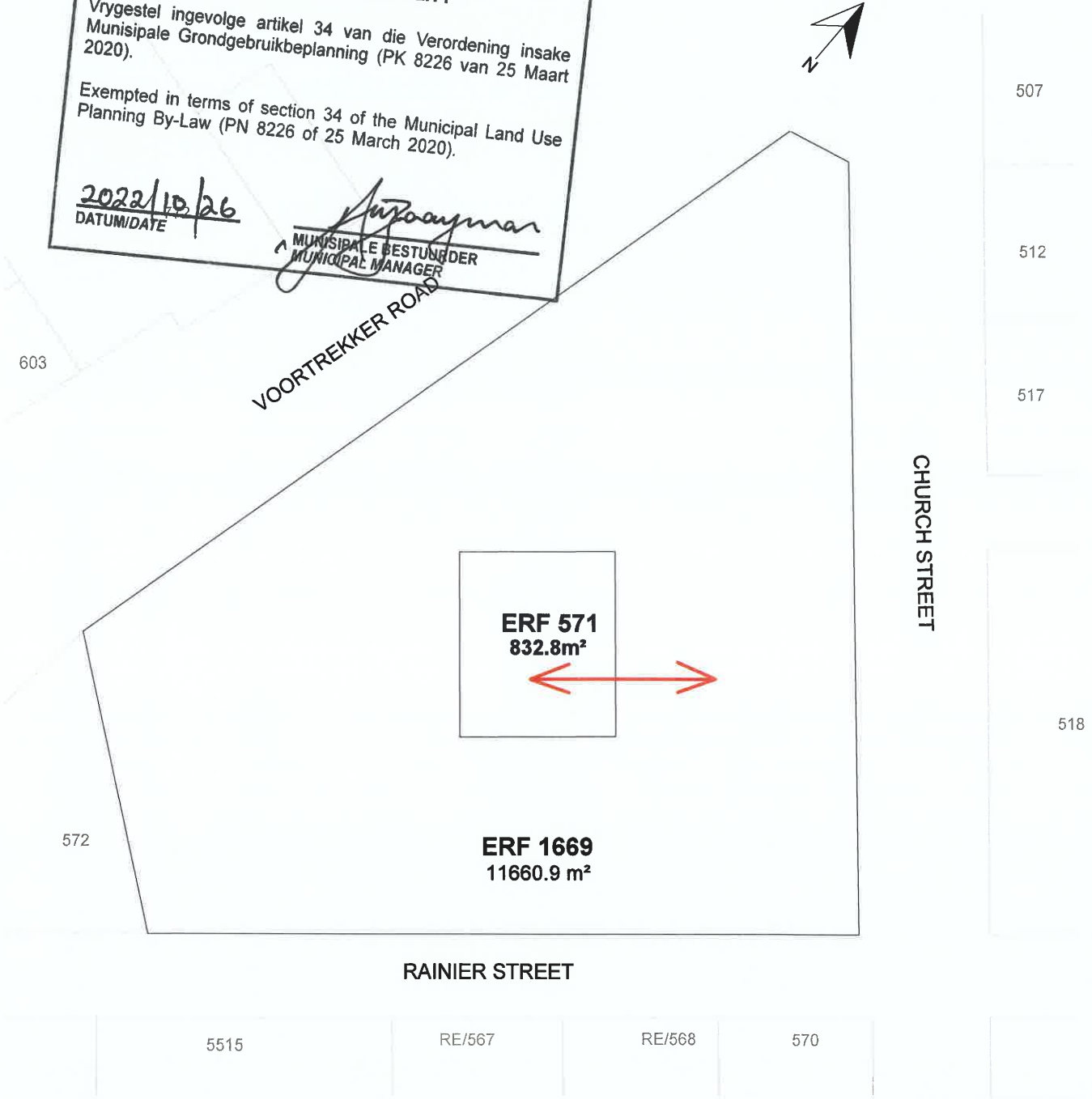

SCALE 1:1000

| BEFORE CONSOLIDATION | | | |
|----------------------|------------------------|------------------|-----------|
| | Area | Zoning | Land Use |
| Erf 571 | 832.8 ² | Authority Zone 1 | Town Hall |
| Erf 1669 | 11660.9m ² | Authority Zone 1 | Municipal |
| AFTER CONSOLIDATION | | | |
| | Area | Zoning | Land Use |
| Property | 11660.9 m ² | Authority Zone 1 | Municipal |

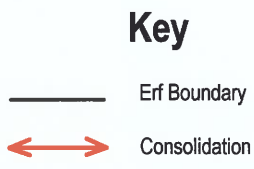

ALL AREAS AND DISTANCES ARE SUBJECT TO SURVEYING

C.K. RUMBOLL & VENNOTE
TOWN PLANNERS
PROFESSIONAL SURVEYORS
16 RAINIER STREET, MALMESBURY
Tel: 022 - 4821845
Fax: 022 - 4871661
Email: leap@rumboll.co.za

| | |
|-------------------------|--------------------------------------|
| DATE: October 2022 | AUTHORITY: SWARTLAND MUNICIPALITY |
| REF: MAL/12808/NG/EB | Paper Size: A4 |