



CLEAN AUDITS SINCE 2010/11
SKOON OUDITS SEDERT 2010/11



Ons gee gestalte aan 'n beter toekoms!
We shape a better future!
Sakha ikusasa elingcono!

File ref:

Enquiries:

File ref: 15/3/12-8/Erf 7577, 12378

Enquiries:
A de Jager

25 August 2022

C K Rumboll & Partners
P.O. Box 211
MALMESBURY
7299

Per Registered Post

Dear Sir/Madam

PROPOSED CONSOLIDATION OF ERF 7577 AND ERF 12378, MALMESBURY

Your application with reference number MAL/12442/MH, dated 18 July 2022, on behalf of Fair Cape Buildings (Pty) Ltd., refers.

By virtue of the authority delegated to the Senior Manager: Built Environment in terms of Council Decision No. 4.1 dated 28 March 2019, as determined by Section 79(1) of the Swartland Municipality: Municipal Land Use Planning By-Law (PG 8226 of 25 March 2020), the application for consolidation of Erf 7577 and Erf 12378, Malmesbury, is approved in terms of Section 70 of the By-Law, subject to the conditions that:

1. TOWN PLANNING AND BUILDING CONTROL

- a) Erf 7577 (2 972m² in extent) be consolidated with Erf 12378 (2 855m² in extent) in order to create a new erf of 5 827m² in extent;
- b) A survey diagram of the consolidation be submitted to the Surveyor General for consideration and approval;

2. ELECTRICITY

- a) Only one electricity connection be permitted to the consolidated erf;

3. GENERAL

The approval is, in terms of section 76(2)(w) of the By-Law, valid for 5 years. All conditions of approval be implemented within these 5 years, failing which, the approval will lapse. Should all the conditions of approval be met before the 5 year approval period lapses, the consolidation will be permanent and the approval period will not be applicable anymore.

Yours sincerely

MUNICIPAL MANAGER
per Department Development Services
Adj/ds

Rig asseblief alle korrespondensie aan:
Die Munisipale Bestuurder
Privaatsak X52
Malmesbury 7299
Darling Tel: 022 492 2237

Tel: 022 487 9400
Faks/Fax: 022 487 9440
Epos/Email: swartlandmun@swartland.org.za

Moorreesburg Tel: 022 433 2246

Kindly address all correspondence to:
The Municipal Manager
Private Bag X52
Malmesbury 7299
Yzerfontein Tel: 022 451 2366

Copies:

Director: Civil Engineering Services

Director: Financial Services

Building Control Officer

Surveyor General, Private Bag X9028, Cape Town, 8000

Fair Cape Buildings (Pty) Ltd, P.O. Box 116, Durbanville, 7551

vanzyl.blignaut@faircape.com

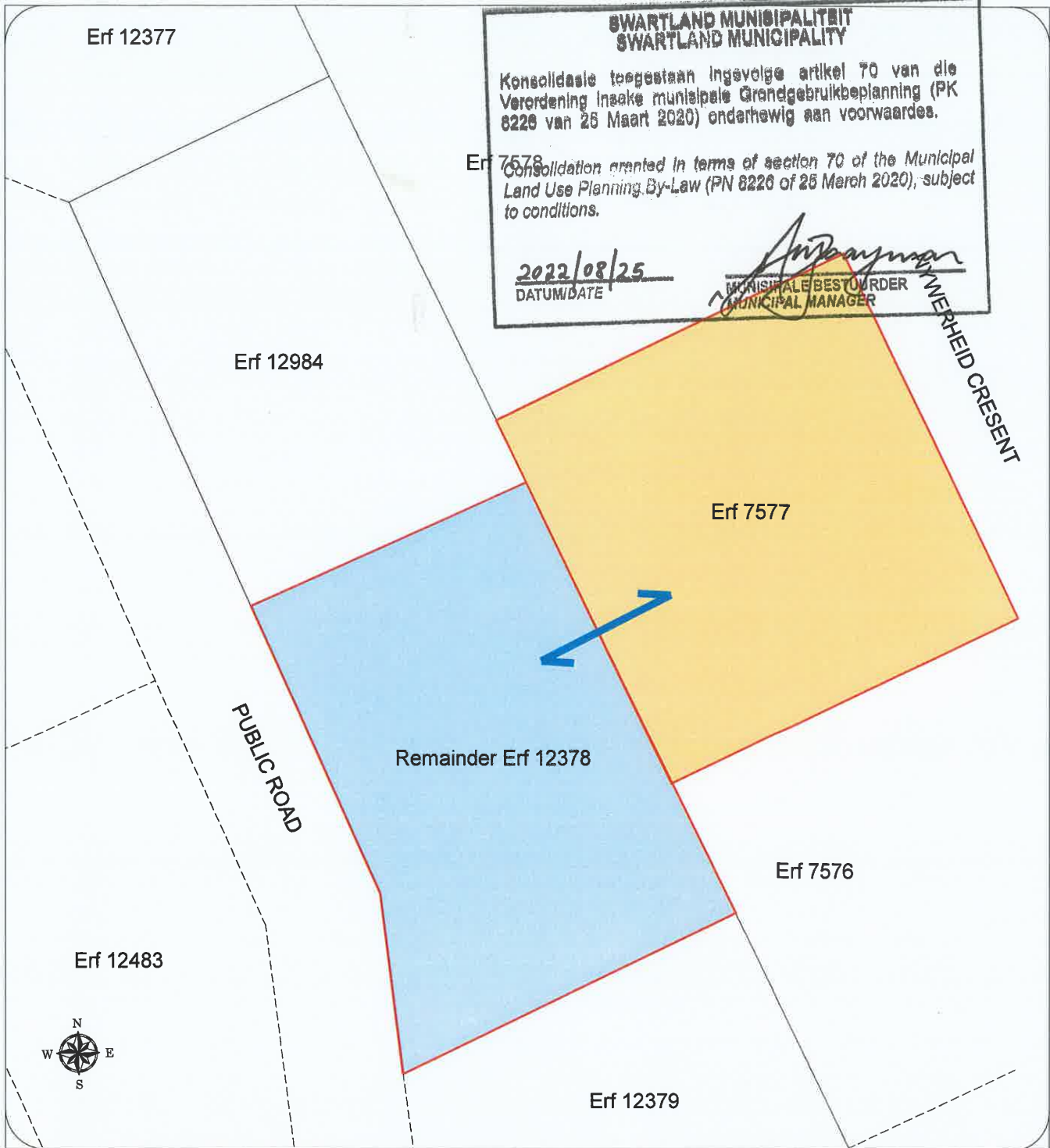

**SWARTLAND MUNISIPALITEIT
SWARTLAND MUNICIPALITY**

Konsolidasie toegestaan ingevolge artikel 70 van die Verordening Inaake munisipale Grondgebruikbeplanning (PK 8226 van 25 Maart 2020) onderhewig aan voorwaardes.

Erf 7578 Consolidation granted in terms of section 70 of the Municipal Land Use Planning By-Law (PN 8226 of 25 March 2020), subject to conditions.

2022/08/25
DATUM/DATE

[Signature]
MUNISIPALE BESTUURDER
MUNICIPAL MANAGER

Consolidation Plan - Erf 7577 and Remainder Erf 12378 Malmesbury

BEFORE	
Remainder Erf 12378	
ZONING	Industrial Zone 2
SIZE	2855m ²
Erf 7577	
ZONING	Industrial Zone 2
SIZE	2972m ²
AFTER	
Newly consolidated land unit	
ZONING	Industrial Zone 2
SIZE	5827m ²

LEGEND:

Property boundaries

Consolidation

PHYSICAL ADDRESS:	
NOTES: All areas and distances subject to final survey	
COMPILED BY: 	C.K. RUMBOLL & PARTNERS TOWN PLANNERS PROFESSIONAL SURVEYORS 16 RAINIER STREET, MALMESBURY Tel: 022 - 4821845 Fax: 022 - 4871661 Email: planning1@rumboll.co.za
DATE: JUNE 2022	AUTHORITY: SWARTLAND MUNICIPALITY
REF: MAL/12442/MH	