



CLEAN AUDITS SINCE 2010/11  
SKOON OUDITS SEDERT 2010/11



Munisipaliteit  
Municipality  
Umasipala

Ons gee gestalte aan 'n beter toekoms!  
We shape a better future!  
Sakha ikusasa elingcono!

File ref: 15/3/13-3/Erf 1107, 1108, 1109 1110

Enquiries:  
A. de Jager

24 October 2022

CK Rumboll & Partners  
P.O. Box 211  
MALMESBURY  
7299

**Per Registered Post**

Dear Sir/Madam

**PROPOSED EXEMPTION FROM APPROVAL FOR THE CONSOLIDATION OF ERF 1107, ERF 1108, ERF 1109 AND ERF 1110, DARLING**

Your application, with reference number DAR/12809/ZN/MV, dated 11 October 2022, on behalf of Swartland Municipality, refers.

- A. The consolidation of Erf 1107, Erf 1108, Erf 1109 and Erf 1110, Darling complies with the requirements of Section 34 of Swartland Municipality: Municipal Land Use Planning By-Law (PG 8226 of 25 March 2020) and is thus exempted from approval from Swartland Municipality.

Kindly provide Swartland Municipality with copies of the approved Surveyor General diagrams for record keeping purposes.

Yours sincerely

  
**MUNICIPAL MANAGER**  
per Department Development Services  
AdJ/ds

Copies: *Land Surveyor General Private Bag X9028, Cape Town, 8000*

# CONSOLIDATION PLAN: ERVEN 1107, 1108, 1109, & 1110, DARLING

**LEGEND:**

→ Consolidation

**NOTES**

This diagram illustrates the proposed consolidation of Erven 1107, 1108, 1109, and 1110, Darling.

Figure ABCLK represents Erf 1108, Darling, with an extent of 680m<sup>2</sup>.

Figure CDEFL represents Erf 1109, Darling, with an extent of 680m<sup>2</sup>.

Figure LFCH represents Erf 1110, Darling, with an extent of 693m<sup>2</sup>.

Figure KLHJ represents Erf 1107, Darling, with an extent of 693m<sup>2</sup>.

Figure ABDEGJ represents the proposed consolidated property, with an extent of 2746m<sup>2</sup>.

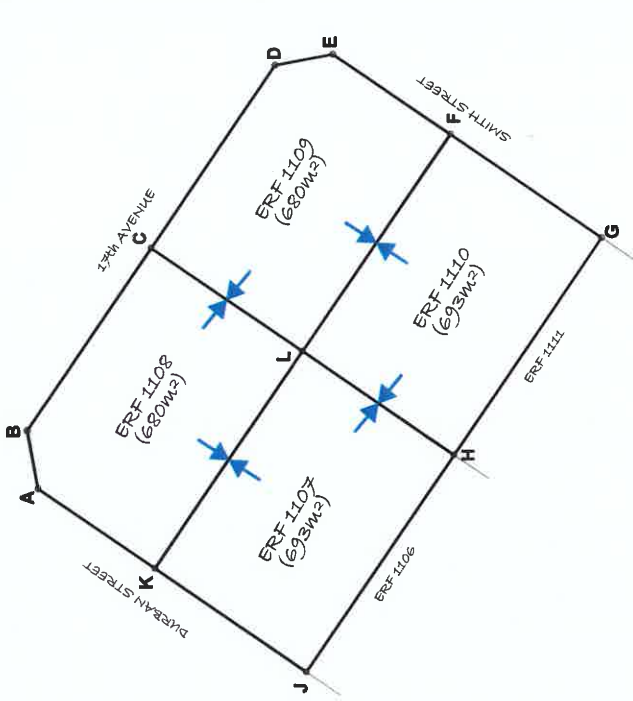

1

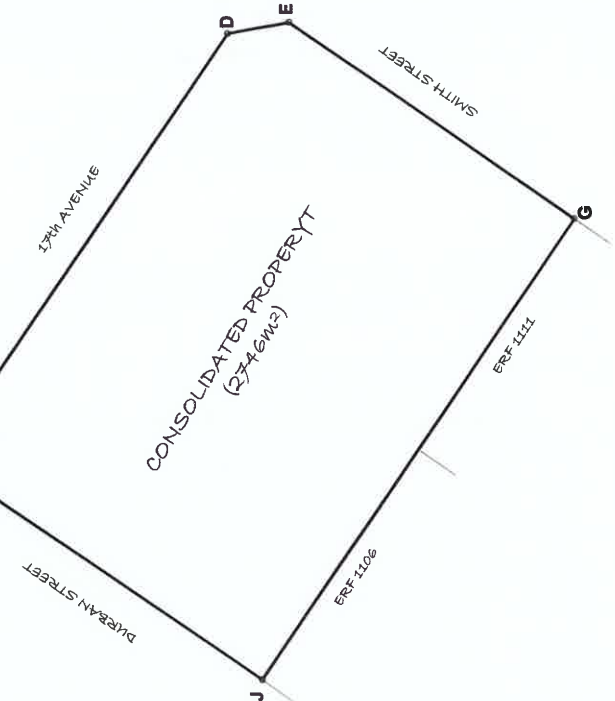

2



**SWARTLAND MUNISIPALITEIT  
SWARTLAND MUNICIPALITY**

Vrygestel ingevolge artikel 34 van die Verordening:  
Munisipale Grondgebruikbeplanning (PK 8226 van 2:  
2020).

Exempted in terms of section 34 of the Municipal Land Use  
Planning By-Law (PN 8226 of 25 March 2020).

2022/10/24  
DATUM/DATE

Approved by  
Municipal Engineer  
Mandi Vignen

C.K. RUMBOLD & VENOTE  
TOWN PLANNERS  
PROFESSIONAL SURVEYORS  
10 PANNER STREET, WILMERSBURG  
Tel: 022 - 4621845  
Fax: 022 - 4671061  
Email: planning@rumbold.co.za



DATE: OCTOBER 2022  
AUTHORITY: SWARTLAND MUNICIPALITY

REF: DAR/20092/MNV

ALL AREAS AND DISTANCES ARE SUBJECTED TO SURVEYING